

D-mine[®] Pen



Welcome to D-mine[®] Pen User Guide

**A guide for patients, families and carers using
the D-mine[®] Pump to administer Dacepton[®].
(Apomorphine Hydrochloride Hemihydrate)**

Adverse event reporting information can be found on the back page.



For people who are using the D-*mine*® Pen and have been prescribed Dacepton®

Welcome to *D-mine*[®] Pen User Guide

This booklet will take you through the key information relating to your *D-mine*[®] Pen. Do not hesitate to contact your healthcare professional or *D-mine*[®] Care nurse advisor with any questions.



Please see the

PATIENT INFORMATION

Leaflet or contact your healthcare professional should you have any questions about *Dacepton*[®].

Our dedicated and highly experienced *D-mine*[®] Care nurse advisors are here to support you, your family and carers and are available to answer any questions or concerns you may have about *Dacepton*[®] and the *D-mine*[®] Pen.



Scan here for the **PATIENT INFORMATION** Leaflet

Before you start

At this stage you may feel a little overwhelmed by the idea of having to inject yourself. As Parkinson's disease develops, symptoms such as stiffness, slowness and pain when moving can become more difficult to control. This is known as being 'OFF'.

Your doctor has determined that you may benefit from **Dacepton®**.



Please note that Dacepton® will leave a green stain on any surface or material it comes into contact with.

Dacepton® is a medicine that may help to reduce the amount of time in the 'OFF' state and reduce the associated symptoms. **Dacepton®** can be administered via the **D-mine® Pen** as shown in this booklet.

Following your Apomorphine Response test you will have been given a prescription and a device suitable for you.

You will have received a:

1 x D-mine® Pen (free of charge)

1 x Carry case

You prescription should state:

Dacepton® cartridges (5 per pack)

which contains your medication.

Pen needles for injection



When you receive your **D-mine® Pen**, you will receive comprehensive instructions by your D-mine Care Nurse advisor or your healthcare professional. Please refer to the **INSTRUCTIONS FOR USE** leaflet provided with packaging should you have any questions.



Before you inject

- Always check the expiry date of your medicine – this is stated on the label on your medication next to the letters EXP.
- Do not use if the solution has turned green, is cloudy or you can see particles in it.

SKINCARE

- Wash your hands and always handle the device and medication with clean hands.
- Clean your skin as per the advice given by your healthcare professional.
- Use a new needle each time you inject.
- Inject into sites such as your abdomen or your outer thighs as shown by your healthcare professional.
- Change your injection site each time.
- Do not inject into a skin fold or scar tissue.
- Do not inject into an area of skin that is sore, red, infected or damaged.



See the skincare section in this booklet for more information.

Using your D-mine[®] Pen

Let's show you what your Pen looks like:

Inner needle protective cap

Pen needle



Pen cap

Outer needle protective cap

What will you need?



D-mine[®] Pen

The **D-mine® Pen** has been designed to be easy to use and this booklet will take you through a step-by-step guide to using the device.

Dacepton® cartridge

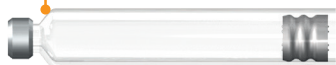

Cartridge sleeve



Simply by twisting
clockwise/ anti-clockwise to
the dose recommended by
your Doctor

Threaded rod



**Dosage
wheel**

Display window

Push button



Dacepton® cartridge (5 per pack)



Pen needles* (100 per box)

*BD Micro-Fine Ultra™ needles are recommended for use with the **D-mine® Pen**. Pen needles from other manufacturers can be used according to their stated compatibility details.

Changing the Cartridge

1

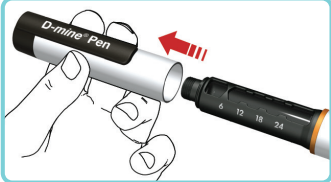

Remove the Pen cap.

2

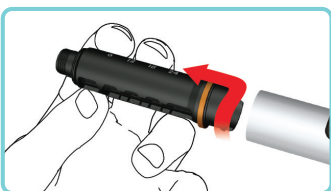

Twist the cartridge sleeve until you hear a click. Remove the empty cartridge if necessary, ensuring that the needle has been removed prior to removal of the cartridge.

3

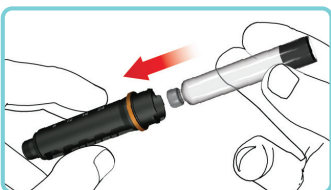

Insert new cartridge.

4

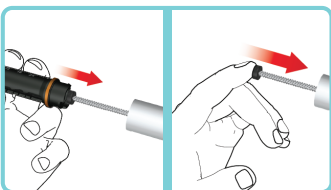

Push threaded rod back completely. Only do this when replacing the cartridge.

5



Push the cartridge sleeve into the housing and turn to lock. You will hear a click.

Attaching the Pen Needle

1

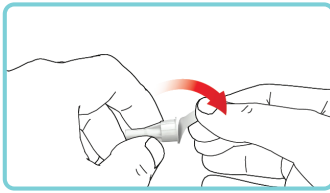

Pull from the needle cap the peel foil.

2

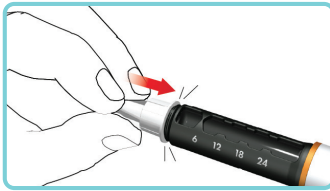

Push on and twist the Pen needle onto the cartridge sleeve.

3

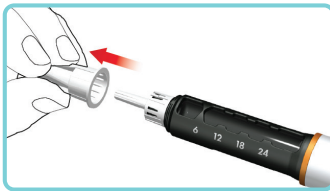

Remove the outer needle protective cap.
(keep this for the disposal of the needle once you are finished injecting)

4

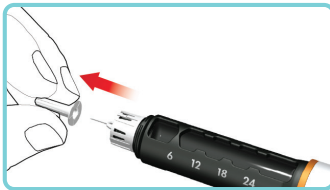

Remove and dispose the inner needle protective cap.



Priming and Function Check



1



Dial the test dose forward by turning the dosage wheel clockwise. Check the dose by looking at the display, so that the symbol is clearly displayed.

2



For the function test, hold the Pen pointing upwards and gently tap the cartridge sleeve, so that the air can rise to the top.

3

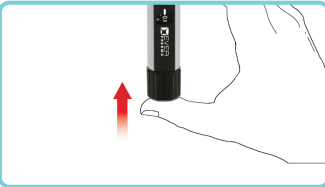

Press the push-button.

4

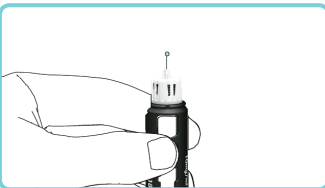

A few drops of medicine will emerge. If no drops emerge, repeat steps 1-4.

Setting the Dose

- 1 Dial the required dose by turning the dosage wheel clockwise. You can correct the dose by dialling anticlockwise if needed. Look at the display to see if you have dialled the required dose.

Injecting

- 1 Press and hold the push-button fully down during the medication discharge.

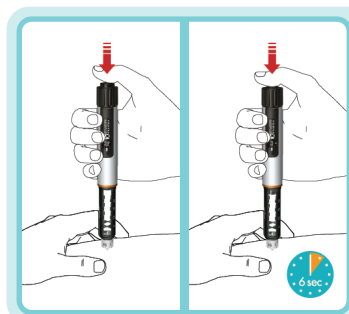

After the medication has been completely discharged, wait for 6 seconds and **ONLY** then pull out the Pen needle.

- 3 Check that the display is 0.0 to confirm full dose delivery.

After your Injection

- 1 Attach the outer needle protective cap to the needle, remove the Pen needle and dispose in accordance with local regulations.
- 2 Attach the Pen cap securely after each use.
- 3 After you have removed the needle, you can change your cartridge if needed.

Caring for your skin

Although Apomorphine is absorbed quickly from the injection site, it can pool under the skin. This can cause skin reactions such as redness, tenderness, itching and the development of nodules (hardening of the skin at the injection site).

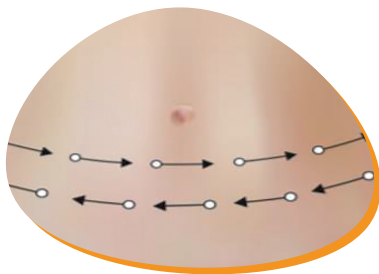

These skin reactions are not dangerous and can be managed through good skincare practices.

Tips

- Always inject at least 1 inch (2.5 cm) away from your belly button and any recent injection sites.
- Insert the needle at 90 degrees to the surface of your skin.
- Keep your skin dry and wipe away any residual drops of **Dacepton®**.
- Massage your skin by hand or with a massage device, as this may help prevent the formation of skin nodules.
- Do not inject into a skin fold or scar tissue and do not inject into an area of skin that is red, sore, infected or damaged.

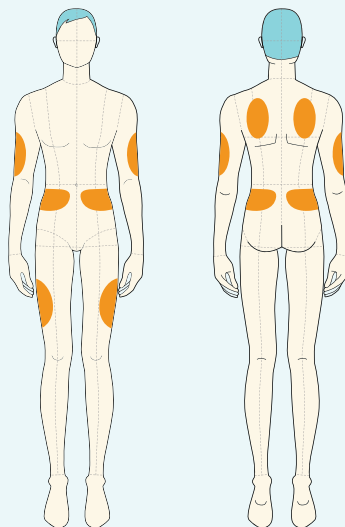

If persistent skin reactions occur, please consult your healthcare professional or your D-mine® Care nurse advisor.

RESPONSE TEST DETAILS

D-*mine*® Care nurse advisor:

Parkinson's Specialist:

Response Test Date:

D-*mine*® Pen Response Test Dose: mg

BP Lying: mmHg

BP Standing: mmHg

DOSAGE RECORD

› Record the dose of Apomorphine and the date you injected

| Date | Daily Dose |
|------|------------|
| | mg |
| | mg |
| | mg |
| | mg |
| | mg |

CARTRIDGE CHANGE RECORD

› This is helpful to know when you need to change your cartridge

(refer to the FAQ section for more information on how long Dacepton® will last after opening)

| Date | Daily Dose |
|------|------------|
| | mg |
| | mg |
| | mg |
| | mg |
| | mg |

FAQs

How do I get hold of my medication?

There are different options available to get hold of your **Dacepton®**.

- You can get your **Dacepton®** and **Pen needles** from your local pharmacy. You will need a prescription from your treating healthcare professional to hand into your chosen pharmacy.
- Homecare (medication delivered to your home) must be agreed by your NHS Trust and is provided by our partner Alcura – your medication and ancillaries will be delivered to your home based on your prescription.



Can I travel with my Pen?

When you go travelling you need to ensure that you have enough **Dacepton®** medication and needles for the period you will be away.

- **You will need to use a new Pen needle each time you inject yourself.**

Your GP can prescribe an additional **D-mine® Pen** if needed, as a spare for travelling.



Ask your D-mine® Care nurse advisor for a copy of the Travel Letter. This can be used if requested by any relevant border officials to explain why you need your Dacepton® medication when travelling abroad.

We recommend carrying your medication in hand luggage to avoid extremes changes in temperature.

What if I go into hospital?

- If you need to go to hospital, try and take as much information as you can about your medication, this booklet might be helpful. You may need to explain your treatments to other healthcare professionals.

How long does Dacepton® last after opening?

- Always check the expiry date of your medicine and do not use if the solution has turned green, is cloudy or you can see particles in it.
- After first opening, **Dacepton®** is stable within the device for 15 days at 25°C (room temperature).
- It is important to clean your hands and the skin you are injecting. **Dacepton®** should be kept in a clean environment to reduce the risk of contamination. Once opened, use the product immediately.
- You should follow instructions and guidance provided by your **D-mine® Care** nurse advisor or your healthcare professional.

What happens if I have a problem with my D-mine® Pen?

- For any troubleshooting or technical support relating to your device please call **0800 254 0175** (Monday–Sunday: 07h00–22h00). Outside of these hours, leave a message and you will receive a call back the next day. Or you can email **ever.pharma@nhs.net**. Your **D-mine® Pen** will be replaced free of charge in the case of a fault.



D-mine[®] Care

Who to contact for support

For support related to your **Dacepton[®]** therapy, please contact your healthcare professional or your **D-mine[®] Care** nurse advisor. Please note, your **D-mine[®] Care** nurse advisor works Monday–Friday, 09h00–17h30. Please **leave a message** when prompted and you will receive a response within 24 hours.

Technical Support

For technical support relating to your device:

- 0800 254 0175 (Monday–Sunday: 07h00–22h00). Outside of these hours, **leave a message** and you will receive a call back the next day.
- email ever.pharma@nhs.net

Prescriptions and ancillaries

For support relating to prescriptions and ordering:

- 0800 254 0176 (Monday –Friday: 08h00–16h00)
- email info.uk@everpharma.com

Adverse Events

Any adverse events should be reported to your healthcare professional. You can also report adverse events directly via the Yellow Card Scheme at www.yellowcard.mhra.gov.uk

Adverse events should also be reported to Medical Information on: 0800 254 0174 or drugsafety@everpharma.com

By reporting adverse events you can help provide more information on the safety of this medicine. Very common side effects include hallucinations and injection site reactions. If you experience these side effects, please discuss them with your healthcare professional.

This booklet has been produced by EVER Pharma in the interests of patient education.

The D-mine[®] Care nurse service is contracted through Bionical Health.

Registered Office: Bionical Health Ltd, The Piazza, Mercia Marina, Findern lane, Willington, Derbyshire, DE65 6DW. No. 15300657

The D-mine[®] Care nurse service can only be engaged after a decision to prescribe Dacepton[®] has been made.

Dacepton[®] and D-mine[®] are registered trademarks of EVER Pharma.

MED-DOC-EVPH-016-v01 Date of preparation: August 2024

