

Two-day infusion set up guide

APO-go® POD

(apomorphine hydrochloride)

CRONO® PAR4 20 Pump

Images used in this booklet are for illustrative purposes only. Persons depicted are models and do not use or endorse APO-go®.

Please also read the Patient Information Leaflet supplied with your apomorphine.

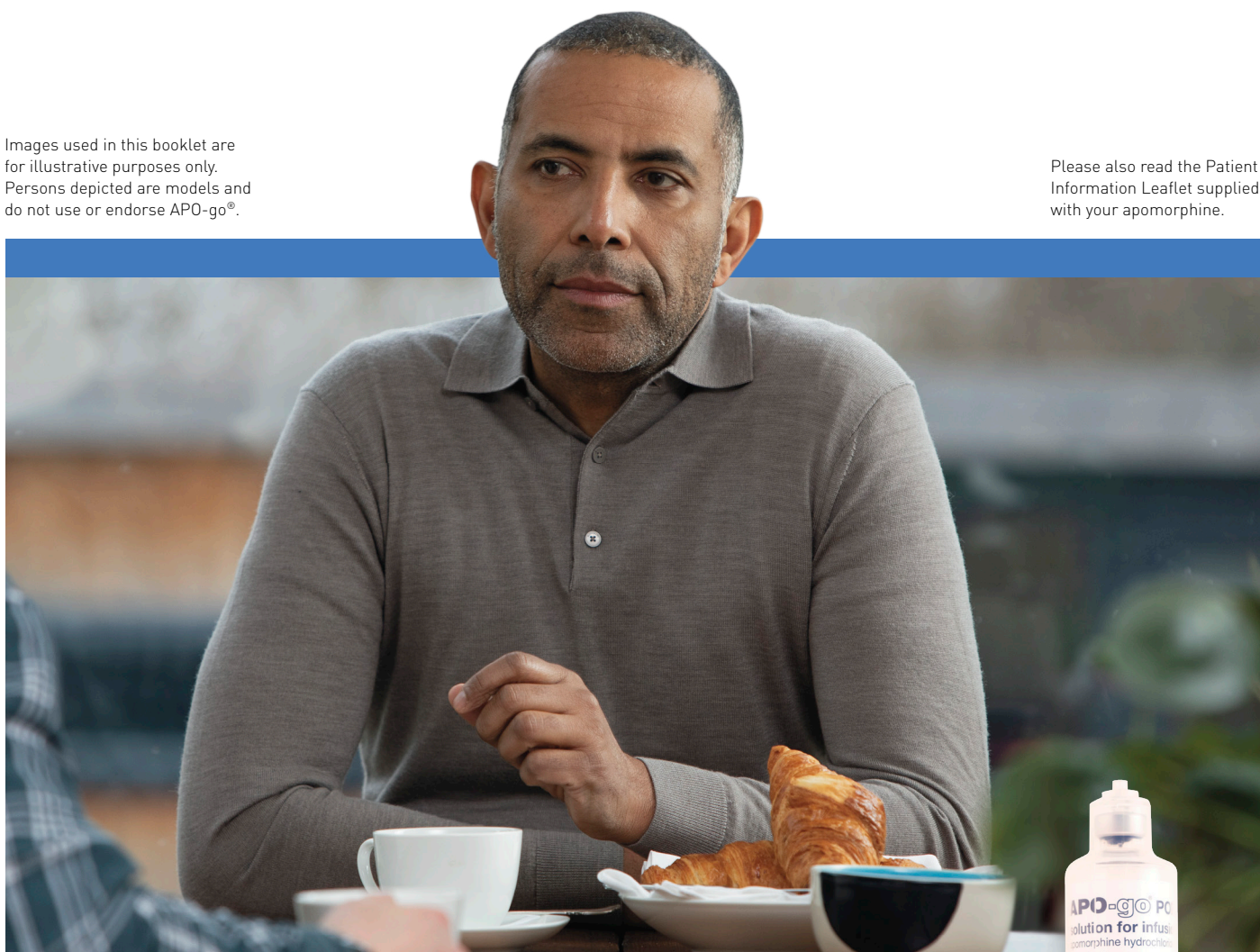

This material is intended for patients who have been prescribed APO-go® POD and their care partners.



If you get any side effects, talk to your doctor, pharmacist or nurse. This includes any possible side effects not listed in the package leaflet. You can also report side effects directly to the Yellow Card Scheme at <http://www.mhra.gov.uk/yellowcard>. By reporting side effects, you can help provide more information on the safety of this medicine.

Setting up APO-go[®] POD with the CRONO[®] PAR4 20 pump

You or someone you know has been prescribed APO-go[®] POD by a healthcare professional. This leaflet provides information about how to set up an infusion using APO-go[®] POD and the CRONO[®] PAR4 20 pump. This guide is intended to be read alongside the information given in the APO-go[®] POD Patient Information Leaflet (PIL) and the pump user manual.

Equipment required

Make sure you have the following 4 items on the preparation tray before you begin:

- A** 1 × CRONO[®] PAR4 20 pump – set up with the plunger fully retracted
- B** 1 × APO-go[®] 20 ml cartridge
- C** 1 × CronoBell Sleeve
- D** 1 × Infusion line

Instructions on how to set up the infusion are on the following pages.

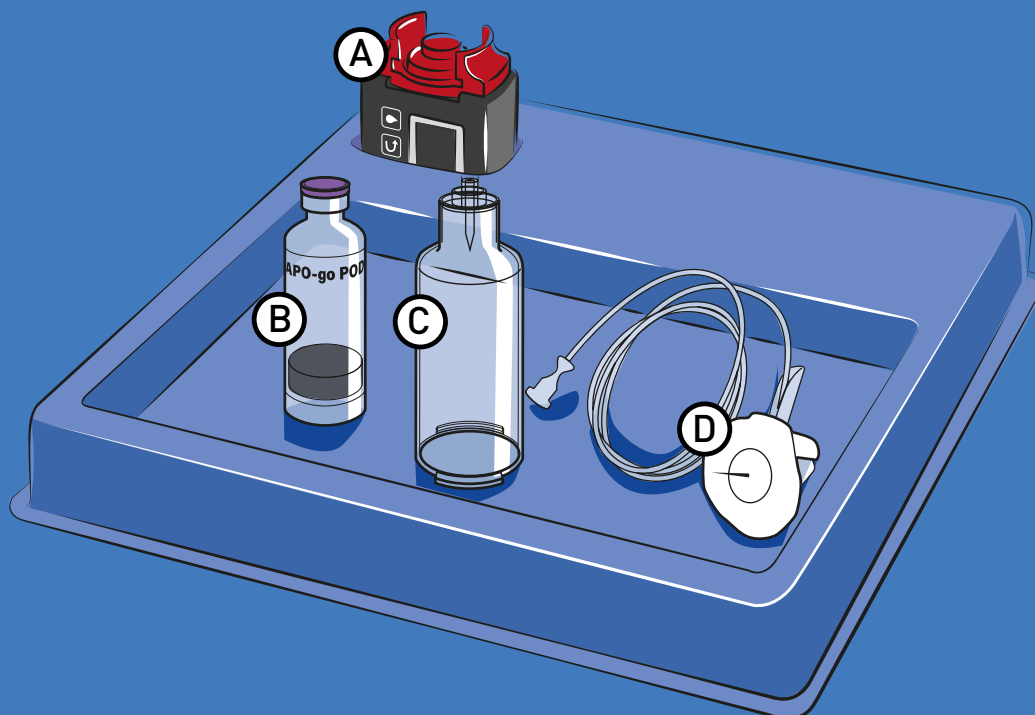

How to set up the infusion – Two-day infusion set up guide

Please follow the steps below to set up the APO-go® POD infusion using the CRONO® PAR4 20 pump for a two-day period.

If you experience any problems, please call the APO-go® Technical Helpline on 0808 196 4242.

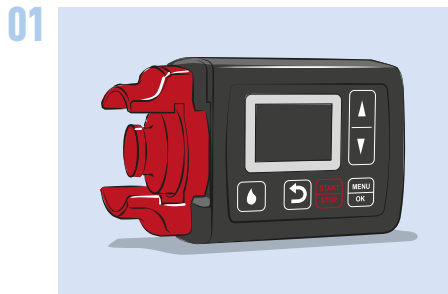

Ensure the CRONO® PAR4 20 pump has the plunger fully retracted.

Wash and dry your hands.

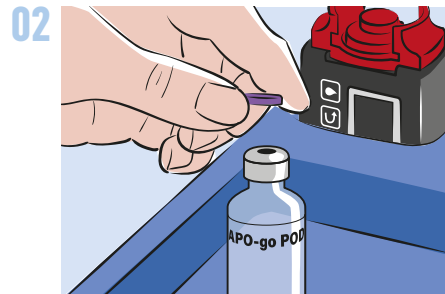

Remove the plastic cap from the cartridge and discard.

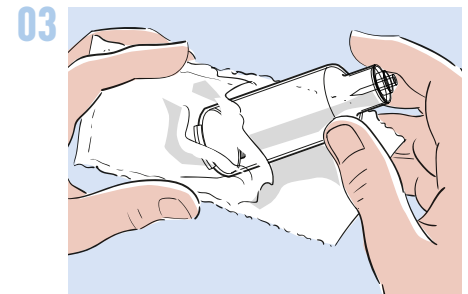

Remove the CronoBell Sleeve from its sterile packaging.

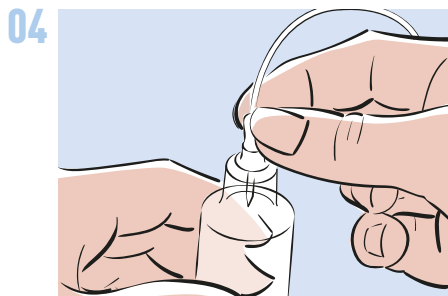

Connect the infusion line to the top of the CronoBell Sleeve and turn clockwise until tight.

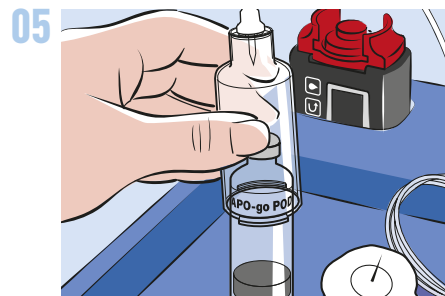

Place the cartridge on a flat surface and push the CronoBell Sleeve firmly down onto the cartridge until the rubber bung in the top of the cartridge is pierced.

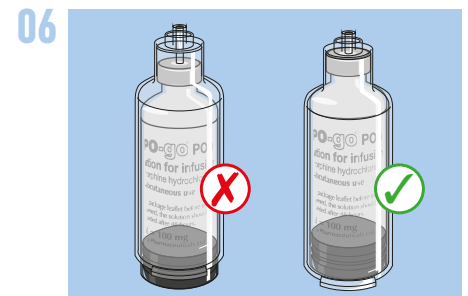

The cartridge should lie flush against the top of the CronoBell Sleeve as shown in the illustration.

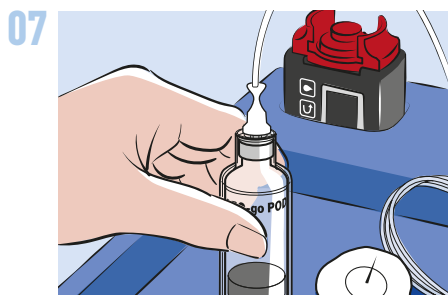

The CronoBell Sleeve (with cartridge and infusion line) is now ready to be connected to the pump.

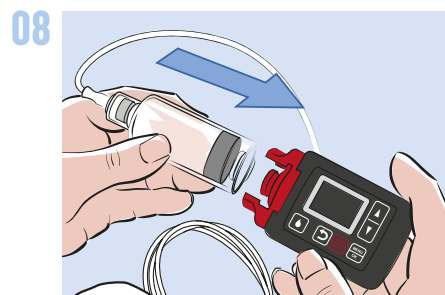

Pick up the CronoBell sleeve with the APO-go® cartridge. Align the outer lip on the CronoBell sleeve with the gap in the collar of the pump.

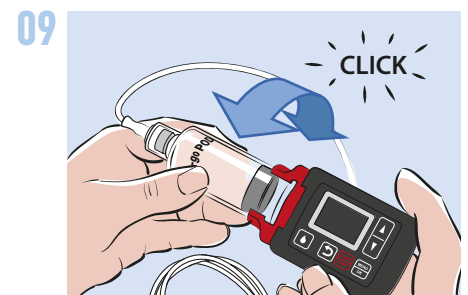

Once inserted, turn the CronoBell Sleeve (with cartridge inside) clockwise until it clicks into place.



Priming the infusion line



If you have been instructed to prime the line by your healthcare professional, press any button to display the screen.



Press and hold **START STOP** button until 'Infusion' appears on screen. Use the **▼** button to select 'Run Prime'. Press **MENU OK**

Starting the infusion



Connect the infusion line as directed by your healthcare professional, ensuring there are no kinks in the infusion line.

'Start' will be highlighted on the screen. Press **MENU OK** to start the infusion.



Stopping the infusion at the end of day 1



Press any button to display the screen. Press and hold **START/STOP** button until you hear a long beep.



When 'Stop' is highlighted. Press 'OK' to stop the infusion.



The screen will display the word 'STOP'.

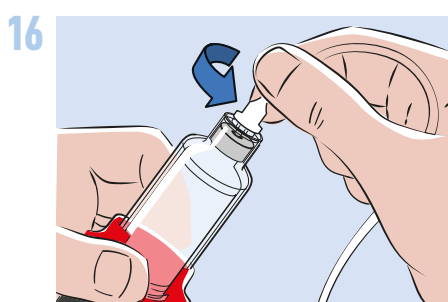

Remove the infusion line from your skin and unscrew the infusion line from the top of the CronoBell Sleeve.

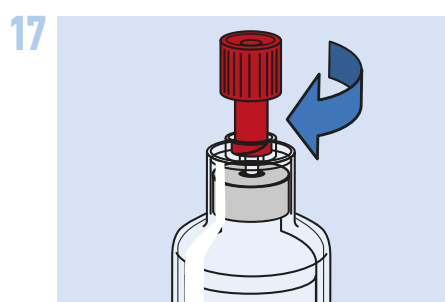

Attach the Luer cap to the CronoBell Sleeve. Place in a safe place ready to use the following day.

DO NOT REMOVE THE CRONOBELL SLEEVE WITH CARTRIDGE INSIDE

Do not store above 30°C.

Any unused solution should be discarded after 48 hours and a new cartridge used.

Starting the infusion on day 2

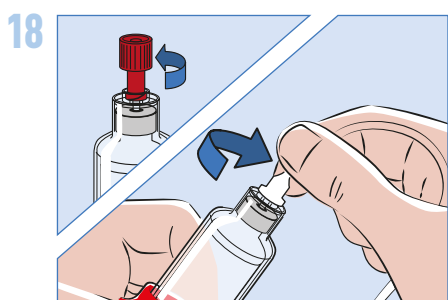

Remove the Luer cap from the CronoBell Sleeve and attach a new infusion line to the CronoBell Sleeve.



Press any button to display the screen on the pump.



Press **START/STOP** to start the infusion. Then immediately press **Water** to prime the line.

The screen will show the 'Bolus dose' and the 'Flow rate' being administered.

Connect the infusion line to your body as directed by your healthcare professional.

Stopping the pump at the end of the infusion on day 2

Before the infusion ends, the pump will beep giving a warning at 10 minutes and 5 minutes before the end of the infusion. Do not remove the CronoBell Sleeve and APO-go® cartridge until the pusher is fully retracted.



The screen will display 'END' and you will hear an audible beep.

Press **MENU OK**

IMPORTANT - Detach the infusion line from your body.



Press **MENU OK** to withdraw the pusher.



The screen will show the pusher 'Reversing'. **This process can take up to 6 minutes.**

Once the pusher has fully withdrawn, detach the CronoBell Sleeve and APO-go® cartridge from the pump and discard as instructed by your healthcare professional.

Stopping the pump before the APO-go® POD infusion has ended

Do not remove the CronoBell Sleeve and APO-go® cartridge until the pusher is fully retracted.



Press any button to display the screen. Press and hold **START STOP** button.



Use the **▼** button to select 'Withdraw pusher' and press **MENU OK**.



Use the **▼** button to select 'YES' and press **MENU OK**.

IMPORTANT - Detach the infusion line from your body.

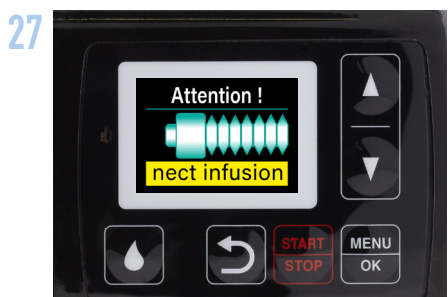

To withdraw the pusher press **MENU OK**.



The screen will display the pusher 'Reversing'. **This process can take up to 6 minutes.**

Once the pusher has fully withdrawn, detach the CronoBell Sleeve and APO-go® cartridge from the pump and discard as instructed by your healthcare professional.

If you get any side effects, talk to your doctor, pharmacist or nurse. This includes any possible side effects not listed in the package leaflet. You can report side effects directly via the Yellow Card Scheme at <http://www.mhra.gov.uk/yellowcard>. By reporting side effects, you can help provide more information on the safety of this medicine.